

LAWNDALE ART CENTER

4912 Main Street

Houston, TX 77002

713 528-5858

Fax 713 528-4140

askus@lawndaleartcenter.org

www.lawndaleartcenter.org

FOR IMMEDIATE RELEASE

Contact Dennis Nance

713-528-5858

dnance@lawndaleartcenter.org

Lawndale Art Center

Presents

A new mural by Jonathan Leach

on view

March 13, 2015 – January 9, 2016

Opening Reception March 13, 2015

6:30 - 8:30 PM

Artist talks at 6 PM

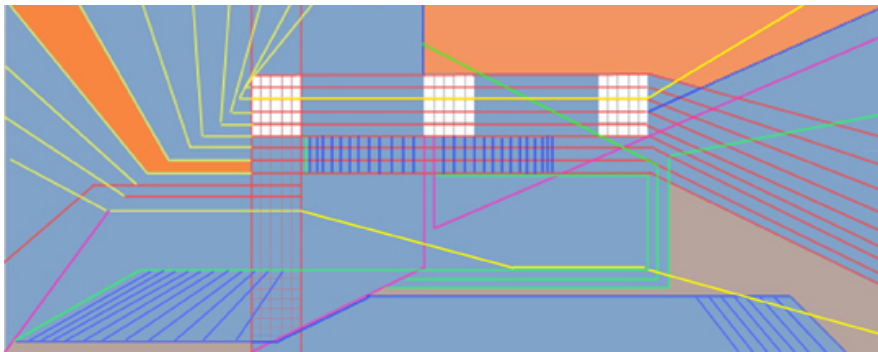

Ghost Grid • Jonathan Leach

North Exterior Wall

Houston, Texas – Lawndale Art Center is pleased to present a new mural by Jonathan Leach at Lawndale Art Center. Jonathan Leach's work focuses on the visual language of commercial architecture, city traffic and safety/cautionary imagery. Leach's mural activates the surrounding architecture and visually impacts the space. *Ghost Grid* features a hardline geometric style with an emphasis on bright color and spatial illusion, using the three windows as a base grid structure that warps and changes, highlighted by reflective paint accents that activate the mural at night.

The new mural, titled ***Ghost Grid***, will open along with four exhibitions on **Friday, March 13, 2015, 6:30 - 8:30 PM**, with artist talks beginning at **6 PM**. The mural will remain on view until January 9, 2016.

This project is generously sponsored by David R. Graham / Felvis Foundation and Kinzelman Art Consulting.

Jonathan Leach is a recipient of an Individual Artist Grant Award. This grant is funded by the City of Houston through Houston Arts Alliance.

CHAIR
VICE CHAIR
VICE CHAIR - MARKETING
VICE CHAIR - FUNDRAISING/DEVELOPMENT
SECRETARY
TREASURER
PROGRAMMING CHAIR

BOARD OF DIRECTORS
NICOLE LAURENT ROMANO
DENISE FURLOUGH
PAULA MURPHY
ELEANOR L. WILLIAMS
VICTORIA LUDWIN
MEGHAN MILLER
KATIA ZAVISTOVSKI

MICHELLE ADAMS
JAMES ANDERSON, JR.
DANIEL ANGUILLU
SARA BECK
NATASHA BOWDOIN
JASON DIBLEY
JOSHUA FISCHER
DENNIS HATCHETT
BRIAN JAMES
ADRIENNE JOHNSON
TIM KOLLATSCHNY
CECILIA MÁRQUEZ
GABRIEL MARTINEZ
JERYN WOODARD MAYER
KATE McCONNICO
BARBARA FRIEDEL McKNIGHT
MEGHAN MILLER
CALI ALVARADO PETTIGREW
BRITT THOMAS
DAVID THOMAS
SANDRA ZALMAN

EMERITUS
GRACIE CAVNAR
TIM CROWLEY
JONATHAN DAY
ANITA GARTEN
ANN HARITHAS
DIANA HUDSON
CECILY E. HORTON
KAROL KREYMER
MARSHAL LIGHTMAN
BROOKE STROUD
JAMES SURLS

STAFF
CHRISTINE JELSON WEST
Executive Director

DENNIS NANCE
Exhibitions and Programming
Director

EMILY LINK
Community Relations Coordinator

KELLY MONTANA
Operations Manager

CINTHIA GOMEZ
Exhibitions Assistant

KATIE SHOCKNEY
Graphic Design Intern

- MORE -

LAWNDALE ART CENTER

4912 Main Street

Houston, TX 77002

713 528-5858

Fax 713 528-4140

askus@lawndaleartcenter.org

www.lawndaleartcenter.org

ABOUT THE ARTIST:

Jonathan Leach is a painter/sculptor currently living and working in Houston, Texas. After receiving a BFA from The School of the Art Institute of Chicago in 2001, Jonathan has exhibited his work nationally, exploring the language of architecture, advertising, and traffic in his abstract works. Jonathan has had solo shows at Gallery Sonja Roesch, the Galveston Arts Center and galleryHOMELAND, created public sculpture in the form of a putt putt challenge incorporated in Discovery Green's "Insperity Golf Experience", and will be producing a large mural for the north wall of Lawndale Art Center in March of 2015. Leach's work was featured in the 2013 Texas Biennial. His work is also in the collections of NRG Texas, Hess Co., the Bank of Montreal, Hobby Airport of Houston, and the Museum of Fine Arts Houston. Jonathan is represented by Gallery Sonja Roesch in Houston, Texas, Cambia Art in Austin, Mirus Gallery in San Francisco, California, and Piero Atchugarry Gallery in Tierra Garzon, Uruguay.
plasticagenda.info

About Lawndale:	Lawndale Art Center develops local contemporary artists and the audience for their art. Lawndale is dedicated to the presentation of contemporary art with an emphasis on work by Houston artists. Lawndale presents exhibitions, lectures and events, and offers an annual residency program to further the creative exchange of ideas among Houston's diverse artistic, cultural and student communities.
Address:	4912 Main St., Houston, TX 77002
For More Info:	www.lawndaleartcenter.org or askus@lawndalwartcenter.org
Gallery Hours:	Monday-Friday, 10-5; Saturday, 12-5; Closed Sunday
Admission:	Free
Press Contact:	Dennis Nance, 713-528-5858, dnance@lawndaleartcenter.org

Programs at Lawndale are supported in part by The National Endowment for the Arts, Andy Warhol Foundation for the Visual Arts, The City of Houston through the Houston Museum District Association, The Texas Commission on the Arts, Houston Endowment, The Brown Foundation, Inc., The John R. Eckel, Jr. Foundation, The John P. McGovern Foundation, The Joan Hohl and Roger Wich Foundation, Felvis Foundation/David R. Graham, Mid-America Arts Alliance, John M. O'Quinn, Gracie and Bob Cavnar, Cecily E. Horton, Ann W. Harithas, Diana M. Hudson and Lee Kaplan, Julia and Luke Burke, Monica Rios and Colin Fulton, Samantha Schnee and Michael Hafner, Henke Law Firm LLP, Jenny and Mark Johnson, Gretchen and Andrew McFarland, Paula Murphy, Lia and David Rodi, Nicole and Joey Romano, Scott R. Sparvero, Mary Martha and Joel Staff, Nancy and Sidney Williams, Nina and Michael Zilkha, TeleFlex, United Airlines, Kinzelman Art Consulting, Number 4 High Performance Hair Care, Page, Poggenpohl Design Studio, and other contributors, memberships, benefit events and volunteers.

- END -